

GOODMAN PARK ICE RINK STORM SEWER IMPROVEMENTS

CONTRACT NUMBER 7854
MUNIS NO. 17434-51-200

STORM SEWER
DESIGNED BY:



City of Madison
Department of Public Works
PARKS DIVISION
City-County Building, Suite 104
210 Martin Luther King, Jr. Blvd.
PO Box 2987
Madison, WI 53701-2987

play
**MADISON
PARKS**



INDEX OF SHEETS

SHEET NO.	TITLE
1	
P1	SITE ACCESS AND EROSION CONTROL
P2	PIPE LINING DETAILS
P3	TRAFFIC CONTROL PLAN

PROJECT LOCATION

CONVENTIONAL SIGNS
FIELD VERIFY ALL UTILITY LOCATIONS

GAS	G
STORM SEWER	ST
SANITARY SEWER	SAN
WATER	W
OVERHEAD ELECTRIC	OH
POWER POLE	□

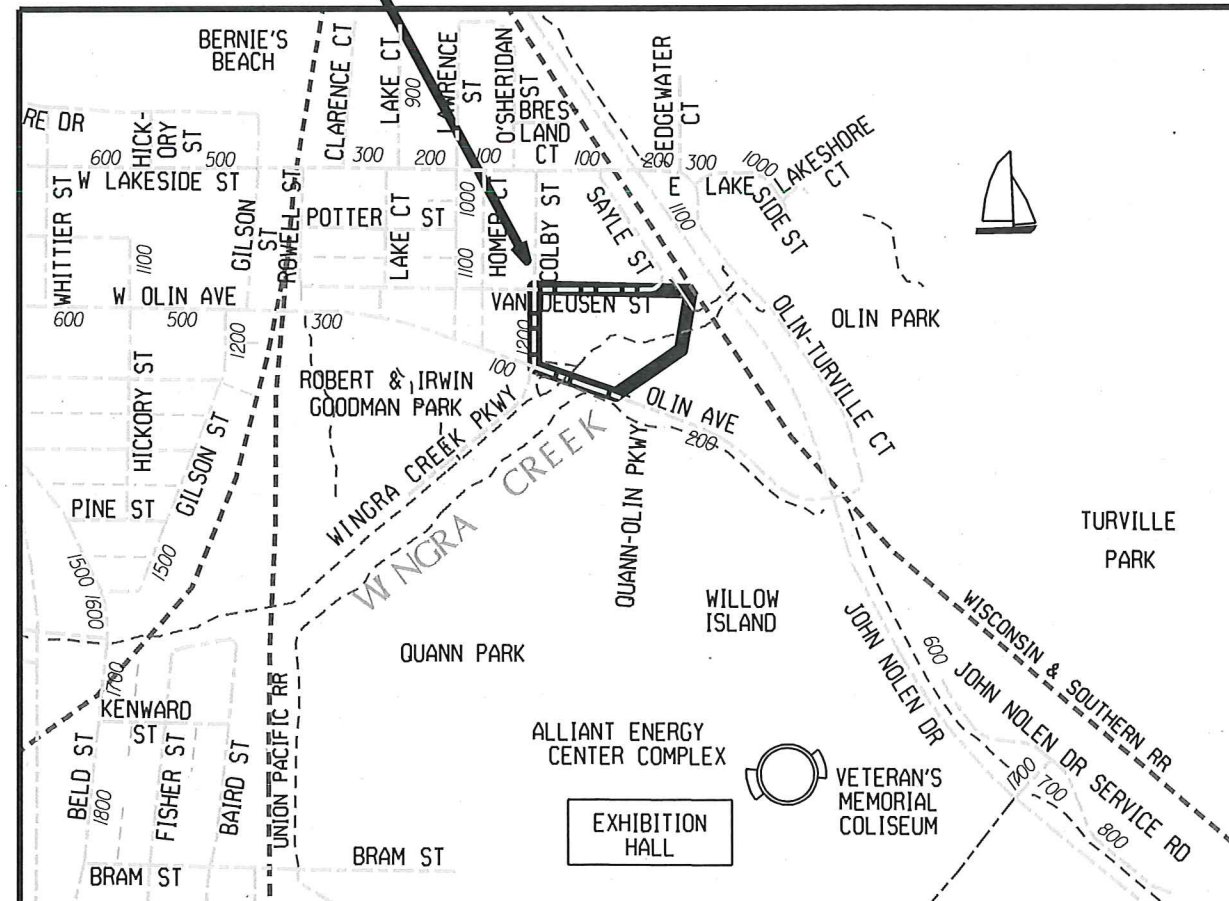
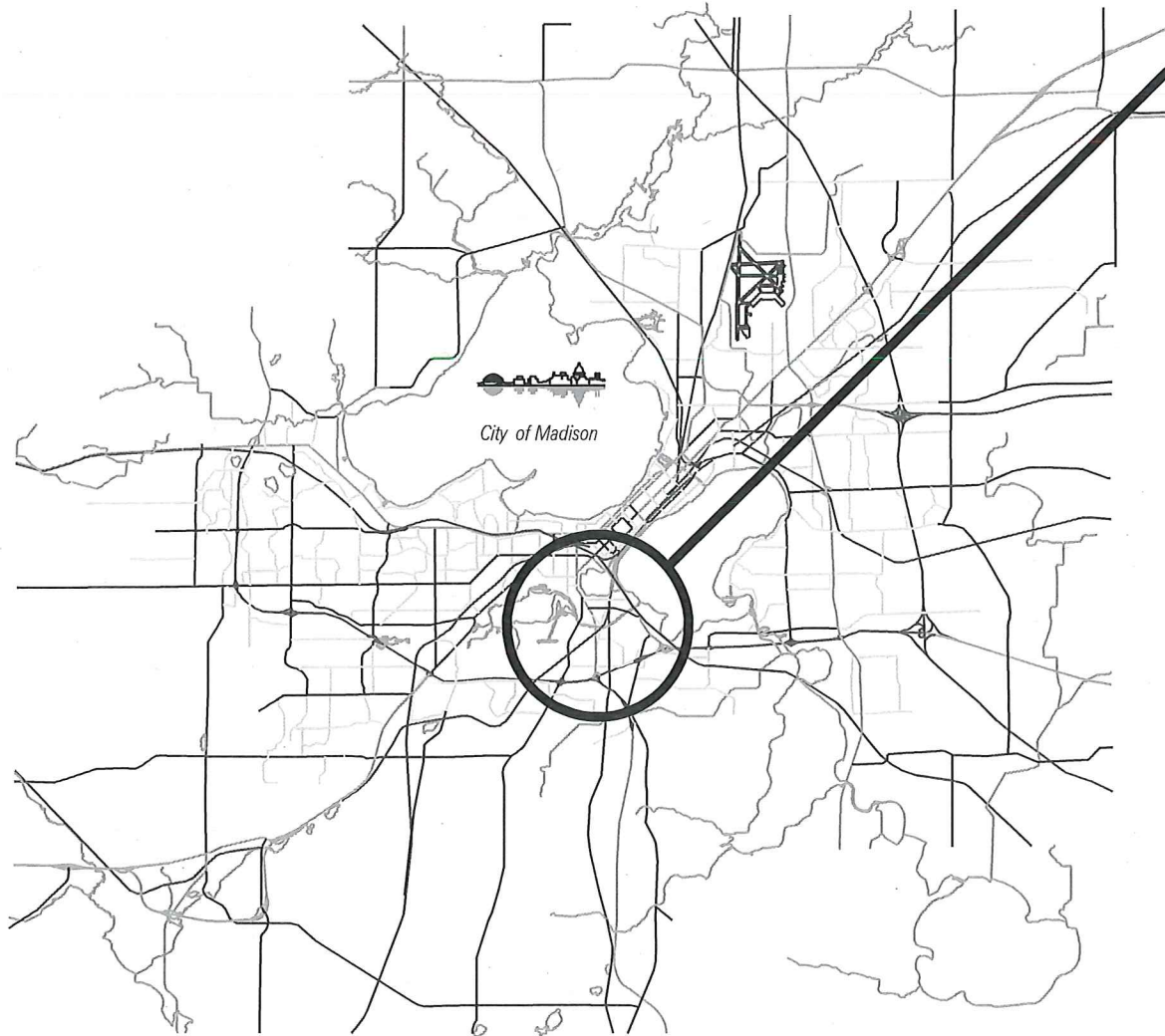

PROJECT:

GOODMAN PARK ICE
RINK STORM SEWER
LINING 2016

GOODMAN PARK
ICE RINK
37 VAN DEUSEN ST
MADISON, WI 53703

Although every effort has been made in preparing these plans and checking them for accuracy, the contractor and subcontractors must check all details and dimensions of their trade and be responsible for the same.

ITEM	DATE
Drawn by: CCS	12-2-16
Revised by:	

SHEET TITLE:

TITLE

SHEET NUMBER:

1

VAN DEUSEN ST

COLBY ST

ICE SKATING RINK AND FISH REARING POND (FLOODED APPROX DEC 1 - MAY 15)

RINK LIGHTING BASES AND POLES

EX 29"X45" CMP STORM PIPE





PROTECT TREE

WINGRA CREEK

BIKE PATH

BIKE PATH

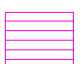
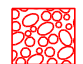
CAUTION: EXISTING UTILITY CROSSING CONTRACTOR SHALL PROTECT UTILITY FROM DAMAGE. ANY DAMAGE TO UTILITY DURING CONSTRUCTION SHALL BE REPAIRED AT NO ADDITIONAL COST TO THE CITY. (TYP)

-  EQUIPMENT STAGING AREA BOUNDARY (GRAVEL)
-  SITE ACCESS ROUTE
-  CONSTRUCTION FENCE
-  ESTIMATED DISTURBED AREA (SEED AND MAT)
-  CONSTRUCTION ENTRANCE STONE PAD
-  TURBIDITY BARRIER

City of Madison
Department of Public Works
PARKS DIVISION

City-County Building, Suite 104
210 Martin Luther King, Jr. Blvd.
PO Box 2987
Madison, WI 53701-2987

play
MADISON PARKS

Graphical Scale
0 50 ft 

PROJECT:
GOODMAN PARK ICE RINK STORM SEWER IMPROVEMENTS

GOODMAN PARK ICE RINK 37 VAN DEUSEN ST MADISON, WI 53703

Although every effort has been made in preparing these plans and checking them for accuracy, the contractor and subcontractors must check all details and dimensions of their trade and be responsible for the same.

ITEM	DATE
Drawn by: CCS	12-2-2016
Approved by:	

SHEET TITLE:
SITE ACCESS AND EROSION CONTROL

SHEET NUMBER:
P-1

City of Madison
Department of Public Works
PARKS DIVISION

City-County Building, Suite 104
210 Martin Luther King, Jr. Blvd.
PO Box 2987
Madison, WI 53701-2987



Graphical Scale

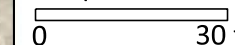

PROJECT: **GOODMAN
PARK ICE
RINK STORM
SEWER
IMPROVEMENTS**

**GOODMAN PARK
ICE RINK
37 VAN DEUSEN ST
MADISON, WI 53703**

Although every effort has been made in preparing these plans and checking them for accuracy, the contractor and subcontractors must check all details and dimensions of their trade and be responsible for the same.

ITEM	DATE
Drawn by: CCS	12-2-16

Approved by: _____



SHEET TITLE:

**PINE LINING
DETAILS**

SHEET NUMBER:

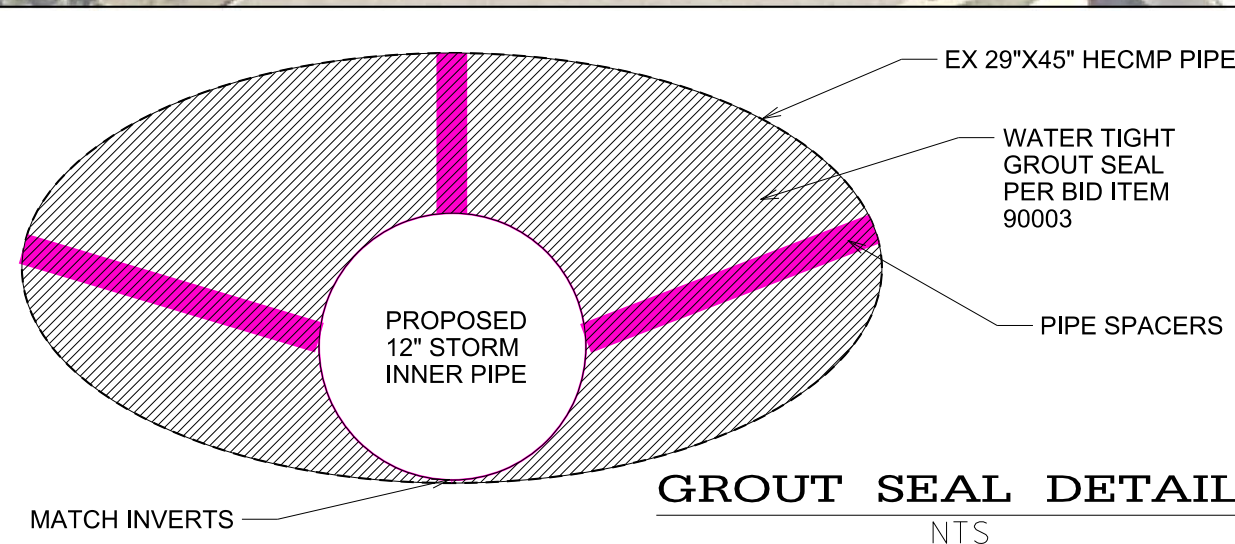
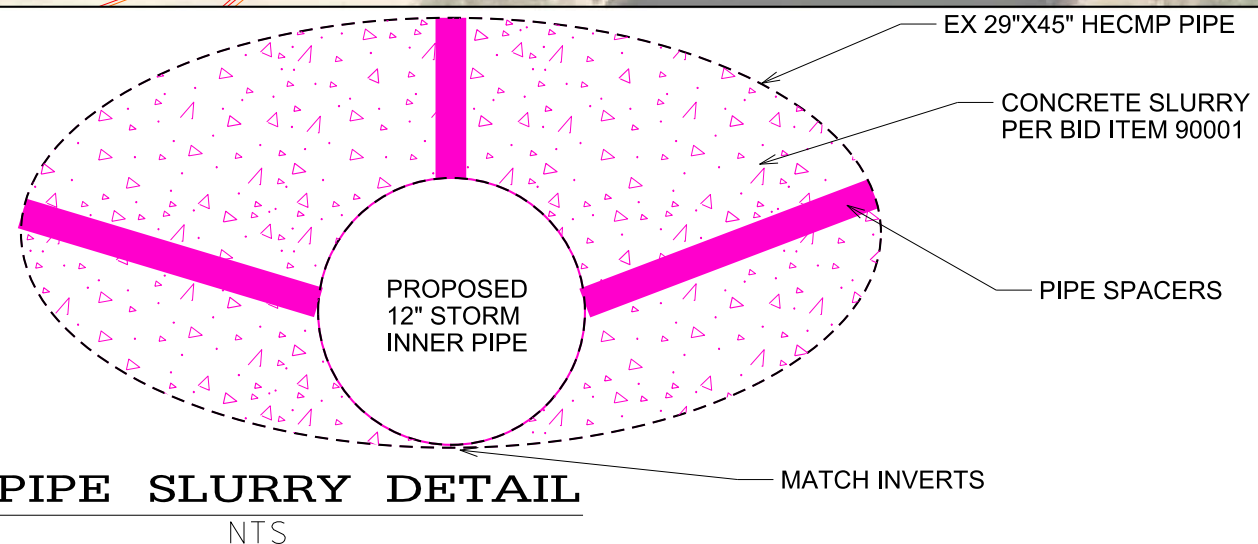
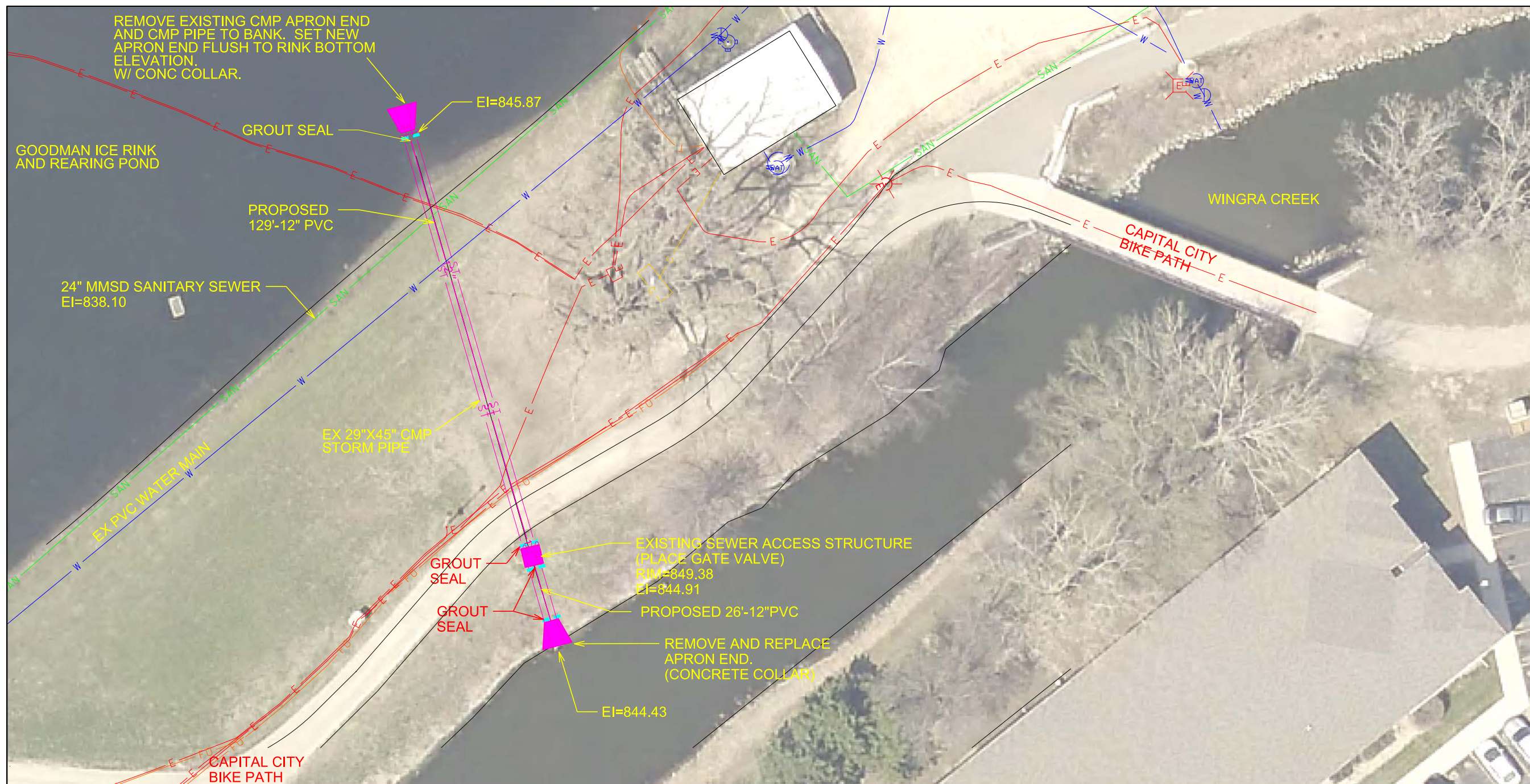
P-2



 BIKE PATH TO BE CLOSED
 SIGN
 BARRICADE AND SIGN

PER SECTION 107.7:
 PATH CLOSURE ALLOWED FOR MAXIMUM OF 5 CALENDAR DAYS.
 PATH MUST REMAIN OPEN ON ALL WEEKENDS.

City of Madison
 Department of Public Works
PARKS DIVISION

City-County Building, Suite 104
 210 Martin Luther King, Jr. Blvd.
 PO Box 2987
 Madison, WI 53701-2987



Graphical Scale
 0 100 ft 

PROJECT:
**GOODMAN
 PARK ICE RINK
 STORM SEWER
 LINING**

**GOODMAN PARK
 ICE RINK
 37 VAN DEUSEN ST
 MADISON, WI 53703**

Although every effort has been made in preparing these plans and checking them for accuracy, the contractor and subcontractors must check all details and dimensions of their trade and be responsible for the same.

ITEM DATE
 Drawn by: CCS 9-15-16

Approved by:

SHEET TITLE:
**TRAFFIC CONTROL
 PLAN**

SHEET NUMBER:
P-3

